

# ROTARY WET DRY SHAVER

Item No: P069

Instructions for Use v001: 20/06/24

Please read and retain these instructions for future reference

**Java**  
wellness



**Power Details:** Input Voltage: DC 5V OUTPUT: 3.7V 5W

**Accessories:** Face Cleansing Brush, Hair Clipper Kit and Nose Trimmer, USB Charging Cable, Charging Base, Instruction Manual

Please read this instruction manual thoroughly before starting and ensure you are familiar with the operation of your new Rotary Wet Dry Shaver.

## **Charge:**

Make sure the product is power-off before the charge. The charge lasts about 2 hours. It's better for the product not to be connected to the power supply for more than 24 hours. (Remark: Digital power display when charging 99 means full.)

1. Insert the product charger into the shaver.
2. Plug in the charger or place on the charging base
3. The charge indicator lights up.
4. After the full charge, unplug the charger and also pull off the product's plug from the shaver.

## **Shaving:**

1. Press the button to start the shaver.
2. Make the shaver head part move quickly on the skin in straight lines and circles.
3. Cover the shaver's protective cover after using, to avoid being damaged.
4. The shaver can run for ten days after a full charge.

### **Cleaning& Maintenance:**

To ensure a better shaving effect, the shaver must be cleaned regularly. The easiest and most sanitary way to clean the product is to wash the shaver head part and the whisker storeroom with water each time after using it.

**Do be careful while using hot water. Do remember to check the water is not too hot to avoid harming hands. Every day: the shaver head part and the hair storeroom.**

1. Cut off the power supply of the shaver, then unplug the charger and also pull out the product, plug from the shaver.
2. Open the shaver head part.
3. Clean the shaver head part and the hair storeroom with hot running water. Make sure both of the shaver head part and the hair storeroom be cleaned thoroughly.
4. Wash the product s surface.
5. Close the shaver head part and throw off surplus water.

Do not wipe the shaver head part with a towel or paper Tissues, which may cause damages to the shaver head.

6. Open the shaver head part again and remain so to dry up the product.

You can also use the brush included to clean the hair storeroom. Here water should not be used.

### **WARNINGS AND SAFETY INSTRUCTIONS:**

WHEN USING ELECTRICAL APPLIANCES, BASIC SAFETY PRECAUTIONS SHOULD ALWAYS BE FOLLOWED:

- READ ALL INSTRUCTIONS BEFORE USE.
- FOR DOMESTIC INDOOR USE ONLY.
- DO NOT USE OUTDOORS OR FOR COMMERCIAL USE.
- ONLY USE WITH THE MAINS ADAPTOR/CHARGER SUPPLIED.
- **DO NOT** USE ANY OTHER MAINS ADAPTOR/CHARGER AS THIS MAY CAUSE DAMAGE AND INVALIDATES ANY WARRANTY YOU MAY HAVE.
- BEFORE USE, CHECK THOROUGHLY FOR ANY DEFECTS AND DO NOT USE IF DEFECTS ARE FOUND. TAKE CARE NOT TO DROP THE APPLIANCE AS HEAVY IMPACTS MAY CAUSE INTERNAL DAMAGE.
- BEFORE CONNECTING THE APPLIANCE, CHECK IF THE VOLTAGE INDICATED ON THE BOTTOM OF THE APPLIANCE IS IN ACCORDANCE WITH THE MAINS VOLTAGE IN YOUR HOME.
- CHECK THE APPLIANCE AND POWER CABLE CAREFULLY FOR DAMAGE BEFORE EACH USE.
- THIS APPLIANCE CAN BE USED BY CHILDREN AGED FROM 8 YEARS AND ABOVE, AND PERSONS WITH REDUCED PHYSICAL, SENSORY OR MENTAL CAPABILITIES OR LACK OF EXPERIENCE AND KNOWLEDGE IF THEY HAVE BEEN GIVEN SUPERVISION OR INSTRUCTION CONCERNING USE OF THE APPLIANCE IN A SAFE WAY AND UNDERSTAND THE HAZARDS INVOLVED. CHILDREN SHALL NOT PLAY WITH THE APPLIANCE. CLEANING AND USER MAINTENANCE SHALL NOT BE MADE BY CHILDREN WITHOUT SUPERVISION.
- CHILDREN OF LESS THAN 3 YEARS SHOULD BE KEPT AWAY UNLESS CONTINUOUSLY SUPERVISED.
- THE USE OF ANY ACCESSORY OR ATTACHMENTS NOT RECOMMENDED BY COOPERS OF STORTFORD MAY CAUSE INJURIES AND INVALIDATE ANY WARRANTY YOU MAY HAVE.
- DO NOT PLACE ON OR NEAR HEAT SOURCES.
- DO NOT COVER THE ITEM IN ANY WAY WHEN IN USE AS THIS MAY CAUSE OVERHEATING.
- DO NOT USE THIS APPLIANCE FOR ANY OTHER USE THAN THE INTENDED USE IT IS DESIGNED FOR.

- TO PROTECT AGAINST ELECTRIC SHOCK, DO NOT IMMERSE POWER CABLE, MAINS ADAPTOR/ CHARGER OR APPLIANCE, IN WATER OR ANY OTHER LIQUID.
- UNPLUG FROM OUTLET WHEN NOT IN USE AND BEFORE CLEANING.
- DO NOT OPERATE ANY APPLIANCE WITH A DAMAGED POWER CABLE OR MAINS ADAPTOR/ CHARGER OR AFTER THE APPLIANCE MALFUNCTIONS OR HAS BEEN DAMAGED IN ANY MANNER. WE RECOMMEND THAT THE POWER CABLE IS NOT KINKED OR STORED IN A TWISTED MANNER, AND THAT YOU REGULARLY CHECK ITS CONDITION.
- DO NOT LEAVE UNATTENDED.
- ANY REPAIRS MUST BE CONDUCTED BY A QUALIFIED ELECTRICIAN OR ELECTRICAL SERVICE AGENT.

### PLUG WIRING (UK & IRELAND)

This appliance is supplied with a mains adaptor/charger with BS1363 plug pins.

**DO NOT** use if the socket outlets in your home or office are not suitable for this product's mains adaptor/ charger plug pins. Attempts to insert the mains adaptor/charger into the wrong socket is likely to cause electric hazard or damage.

**DO NOT** use with any other mains transformer/charger than the one that is supplied with this product.

### CARE AND CLEANING INSTRUCTIONS

- Always switch off and unplug before cleaning.
- Do NOT immerse in water. Risk of electric shock.
- Do NOT use abrasive cleaners or sharp utensils to clean this appliance.
- Wipe surfaces with a soft dry cloth.
- Allow to dry thoroughly before further use.
- Store the appliance in a cool, dry place.

### DISPOSAL

- Coopers of Stortford use recyclable or recycled packaging where possible.
- Please dispose of all packaging, paper, cartons in accordance with your local authority recycling regulations.
- At the end of the product's lifespan please check with your local council authorised household waste recycling centre for disposal.
- Plastics, polybags – this is made from the following recyclable plastic.

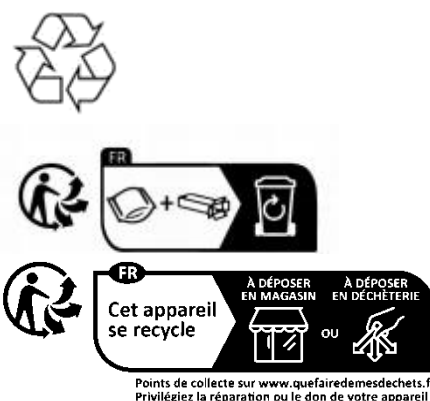

Code & Symbol	 PETE
Type of Plastic	Polyethylene Terephthalate

- At the end of the product's lifespan please check with your local council authorised household waste recycling centre for disposal.

Distributed by / Verteilt durch / Distribué par.

UK:

The Enterprise Department Ltd.  
11 Bridge Street, Bishops Stortford  
Herts, UK, CM23 2JU

Tel: 0330 331 0300

NI/EU:

D.S.B. LD, 160 Bd. de Fourmies, 59100 Roubaix, France

Tel: (+44) 1279 701269

DE/FR/CZ/SK:

hergestellt für 3Pagen

Sankt-Joeris-Strasse 16-28

53477 Alsdorf

Tel: +49(0)2404/980-204

[kontakt@3pagen.de](mailto:kontakt@3pagen.de)

