

# Colour Changing Humidifier

**K811** v002: 10/08/23

Please read and retain these instructions for future reference

# BERGSTRÖM



## Dimensions

(W) 12 x (D) 16cm

Length of mains lead: 150cm

- **POWER: 12W**  
**WATER CAPACITY: 500ML**  
**LED LIGHTS: 3**  
**ACCESSORIES: ADAPTER, MEASURING CUP, MANUAL**  
**TIMER 10SEC, 2HR, 4HR**  
**FEATURES: 7 COLOR CHANGE LIGHTS,**
- **REMOTE CONTROL INCLUDED (Lithium Button Cells Included)**
- **SETTINGS: ON/OFF, INTERMITTENT CONTINUOUS, TIMER**

Model: 24V  
Input voltage: 100-240V ac, 50/60Hz  
Output voltage: DC24V 0.65A  
Power: 12X-14W  
Aerosolized amount: Level 2  
Ultrasonic frequency: 2.4MHz  
Size: 160x160x120mm volume: max 500ml



**CONTAINS LITHIUM  
BUTTON CELLS**

### **BATTERY WARNING**

**KEEP OUT OF REACH OF CHILDREN**  
Swallowing can lead to chemical burns, perforation of soft tissue, and death. Severe burns can occur within 2 hours of ingestion. Seek medical attention immediately.



## ASSEMBLY INSTRUCTIONS / INSTRUCTIONS FOR USE:

Unpack the components carefully. Please check all parts have been removed from the packaging. For best results when used in the bedroom add aromatherapy oil (not supplied) to improve sleep quality.

## Use requirements

1. This product is suitable for use with clean water or pure water. Do not use with corrosive liquids.
2. If the product is not carefully operated, water may leak into the humidifier internally. If there is water leaking, please unplug the power supply immediately, and pour out the water. Clean the body and let stand for about 3 days in a ventilated place. Leave it dry naturally after use.

**WARNINGS AND SAFETY INSTRUCTIONS:**

WHEN USING ELECTRICAL APPLIANCES, BASIC SAFETY PRECAUTIONS SHOULD ALWAYS BE FOLLOWED:

- READ ALL INSTRUCTIONS BEFORE USE.
- **FOR DOMESTIC INDOOR USE ONLY.** DO NOT USE OUTDOORS OR FOR COMMERCIAL USE.
- BEFORE USE, CHECK THOROUGHLY FOR ANY DEFECTS AND DO NOT USE IF DEFECTS ARE FOUND. TAKE CARE NOT TO DROP THE APPLIANCE AS HEAVY IMPACTS MAY CAUSE DAMAGE.
- BEFORE CONNECTING THE APPLIANCE, CHECK IF THE VOLTAGE INDICATED ON THE BOTTOM OF THE APPLIANCE IS IN ACCORDANCE WITH THE MAINS VOLTAGE IN YOUR HOME.
- CHECK THE APPLIANCE AND POWER CABLE CAREFULLY FOR DAMAGE BEFORE EACH USE.
- THIS APPLIANCE CAN BE USED BY CHILDREN AGED FROM 8 YEARS AND ABOVE, AND PERSONS WITH REDUCED PHYSICAL, SENSORY OR MENTAL CAPABILITIES OR LACK OF EXPERIENCE AND KNOWLEDGE IF THEY HAVE BEEN GIVEN SUPERVISION OR INSTRUCTION CONCERNING USE OF THE APPLIANCE IN A SAFE WAY AND UNDERSTAND THE HAZARDS INVOLVED. CHILDREN SHALL NOT PLAY WITH THE APPLIANCE. CLEANING AND USER MAINTENANCE SHALL NOT BE MADE BY CHILDREN WITHOUT SUPERVISION.
- CHILDREN OF LESS THAN 3 YEARS SHOULD BE KEPT AWAY UNLESS CONTINUOUSLY SUPERVISED.
- THE USE OF ANY ACCESSORY OR ATTACHMENTS NOT RECOMMENDED BY COOPERS OF STORTFORD MAY CAUSE INJURIES AND INVALIDATE ANY WARRANTY YOU MAY HAVE.
- DO NOT LET THE POWER CABLE HANG OVER THE EDGE OF A TABLE OR COUNTER, OR TOUCH HOT SURFACES.
- DO NOT PLACE ON OR NEAR HEAT SOURCES.
- USE ON A LEVEL, STABLE SURFACE.
- DO NOT COVER THE ITEM IN ANY WAY WHEN IN USE AS THIS MAY CAUSE OVERHEATING.
- DO NOT USE THIS APPLIANCE FOR ANY OTHER USE THAN THE INTENDED USE IT IS DESIGNED FOR.
- ENSURE THERE IS SUFFICIENT DISTANCE BETWEEN THIS APPLIANCE AND OTHER ITEMS ON THE WORK SURFACE OR WORKSTATION, OR SUFFICIENT DISTANCE BETWEEN THE APPLIANCE AND THE CONFINES OF THE AREA IN WHICH IT IS SITUATED. WE RECOMMEND A MINIMUM CLEARANCE AROUND ALL FACES OF AT LEAST 10CM.
- TO PROTECT AGAINST ELECTRIC SHOCK, DO NOT IMMERSE POWER CABLE, PLUG OR APPLIANCE, IN WATER OR ANY OTHER LIQUID.
- UNPLUG FROM OUTLET WHEN NOT IN USE AND BEFORE CLEANING.
- DO NOT OPERATE ANY APPLIANCE WITH A DAMAGED POWER CABLE OR PLUG OR AFTER THE APPLIANCE MALFUNCTIONS, OR HAS BEEN DAMAGED IN ANY MANNER. WE RECOMMEND THAT THE POWER CABLE IS NOT KINKED OR STORED IN A TWISTED MANNER, AND THAT YOU REGULARLY CHECK ITS CONDITION.
- ANY REPAIRS MUST BE CONDUCTED BY A QUALIFIED ELECTRICIAN OR ELECTRICAL SERVICE AGENT.

## Parts

1. Mist mouth
2. Cover
3. Atomizing chamber
4. Outlet
5. Spray switch
6. Light switch
7. 4 hours timing light
8. 2 hours timing light
9. 10 seconds intermittent light
10. Continuous fog light
11. Power adaptor socket

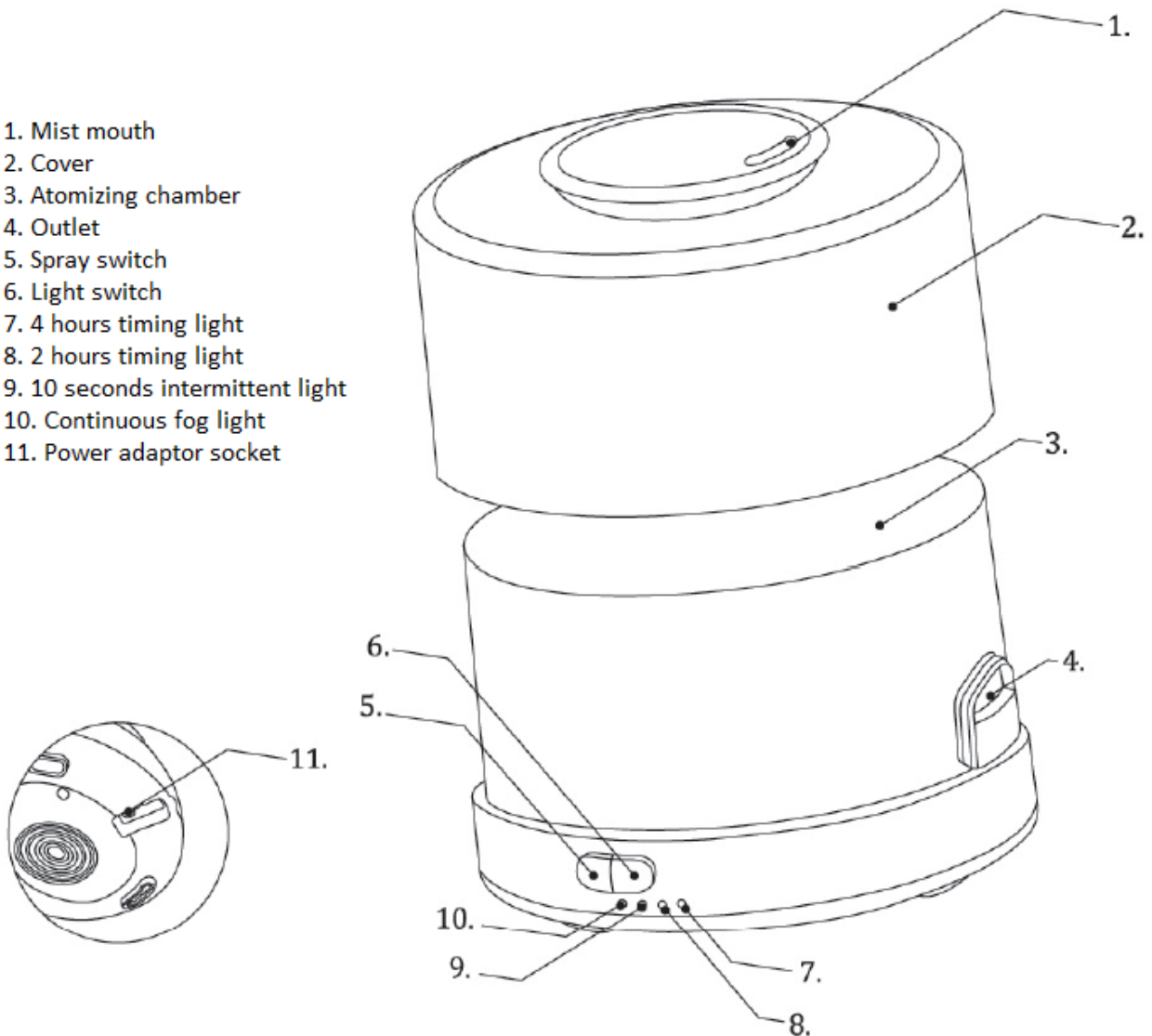

# The Enterprise Department

UK Head Office, 11 Bridge Street, Bishop's Stortford, CM23 2JU

Tel: 0330 331 0300\*, Fax: 01279 756595

[www.coopersofstortford.co.uk](http://www.coopersofstortford.co.uk)

EU address: D.S.B. LD, 160 Bd. de Fourmies, 59100 Roubaix, France

Tel: (+44) 1279 701269

\*UK Calls cost around 7 pence per minute plus your telephone company's network access.  
Please check with your telephone supplier.

## User Guide

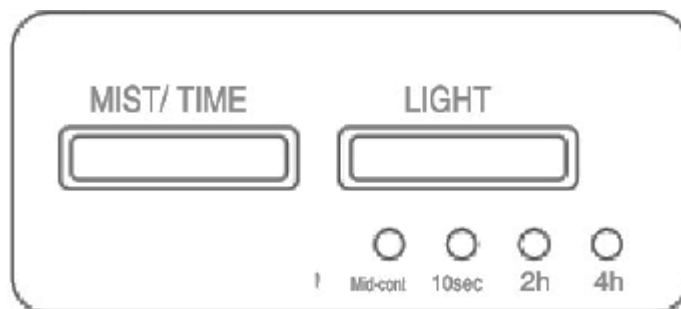

### Mist/Time Spray Switch

Tip: When you press the “MIST/TIME” switch for the first time, the dehumidifier will work in fog mode by default. If you press the “MIST/TIME” switch for 10 seconds, the MID/CONT LED light will flash, and the humidifier will emit low level mist from the nozzle.

1. Press the “MIST/TIME” switch for the first time, the light will come on and mist sprays out.
2. Press “MIST/TIME” switch a second time; the humidifier will work at 10-second intermittent spray mode and stop for 10 seconds mode. The “10-second intermittent signal” lights up.
3. Press the “MIST/TIME” switch a third time, the humidifier works in a 2-hour time mode, with the “2 hours timing signal” lights lit up.
4. Press the “MIST/TIME” switch a fourth time, the humidifier will work in a 4-hour timer mode, with the “4 hours timing signal” lit up.
5. Press the “MIST/TIME” switch a fifth time to turn off the humidifier.

### Light Switch

1. When the humidifier starts working, the light will change into an automatic colourful cycle mode.
2. When the light is circulating and you press the “LIGHT” switch, the current light colour will be set.
3. Press the “LIGHT” switch again to choose your lighting colour and level: press the switch to change to a colour you want each time (with seven different colours to choose from. Each colour has two levels).
4. After browsing the colours, press the “LIGHT” switch again to turn off the light.
5. Press the “LIGHT” switch again to return to the seven-colour automatic cycle mode.

## User instructions

1. Pull the cover up to open

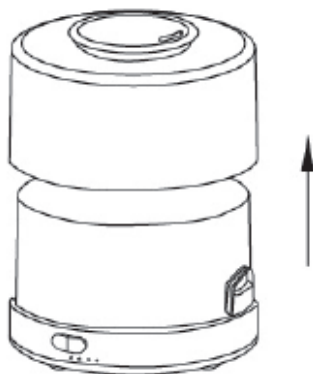

2. Add water to the atomizing chamber



3. Push cover down to close

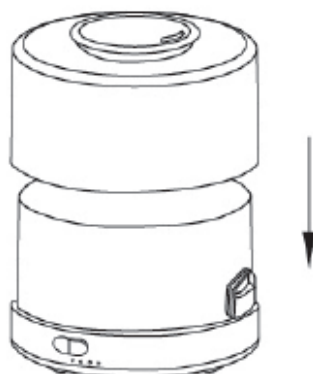

4. Connect to the power supply

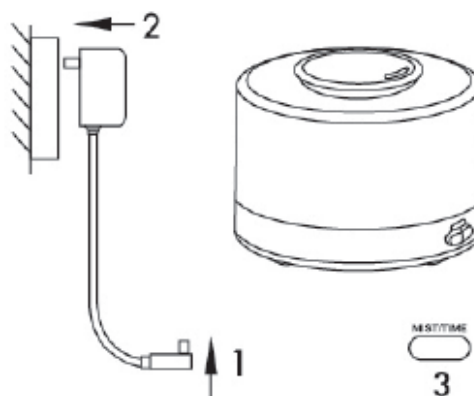

## Remote Control

(Uses 1 x CR2032 battery – included)

1. **ON/OFF button:** Press to turn on, press to turn off.
2. **Intermittent:** Press for intermittent fogging, spray for 10 seconds stop for 10 seconds to extend the spray time switch to Continuous.
3. **Continuous:** For fog output. In intermittent fog mode, press this button to change to continuous fog mode.
4. **Timing:** Spray timing. Press once to set to 120 minutes, press twice to set to 240 minutes.
5. **Big/small:** Output fog, adjust output. When the air is too dry to choose a bigger setting.
6. **Light:** Colour selection, press the button once to cycle, and press it twice to fix the colour.



# The Enterprise Department

UK Head Office, 11 Bridge Street, Bishop's Stortford, CM23 2JU

Tel: 0330 331 0300\*, Fax: 01279 756595

[www.coopersofstortford.co.uk](http://www.coopersofstortford.co.uk)

EU address: D.S.B. LD, 160 Bd. de Fourmies, 59100 Roubaix, France

Tel: (+44) 1279 701269

\*UK Calls cost around 7 pence per minute plus your telephone company's network access.  
Please check with your telephone supplier.

**How to add aromatherapy oil:**

Turn off the power supply, remove the cover, and add aromatherapy oil of your choice to the atomizing chamber. Follow manufacturers' instructions. Then add a suitable amount of water. Close the cover and turn on the power supply.

**Note:**

When adding water, use the scale mark to add the right amount of water to the tank. If the amount of added water is over or under the highest scale, there will be less or more sprayed out. If there is too much water, there will be less steam. Once water level has dropped, there will be more steam.

**Care and Maintenance:**

- Switch off the humidifier at the switch and the power supply.
- Remove the cover and pour out the water in the atomizing chamber from the side showing the "MAX" position.
- Wipe the shell and water tank inside the cavity with a soft cotton cloth.
- Wipe the centre of the tank oscillator gently with cotton buds. This is suggested once every 7 to 14 days.

**Troubleshooting**

Faults	Cause	Action
	No power	Connect the power supply, press the "MIST/TIME" switch
	Not enough water	Add water to the atomizing chamber
No steam	Too much water	Pour out water from the atomizing chamber
	Oscillator is covered by scale	Clean the scale on the oscillator
	Cover or water retaining cover out of the fog on membrane or other foreign bodies covered	Only use cotton buds to clean the centre of the tank oscillator.

**PLUG WIRING (UK & IRELAND)**

This appliance is supplied with a mains adaptor/charger with BS1363 plug pins.

**DO NOT** use if the socket outlets in your home or office are not suitable for this product's mains adaptor/charger plug pins. Attempts to insert the mains adaptor/charger into the wrong socket is likely to cause electric hazard or damage.

**DO NOT** use with any other mains transformer/charger than the one that is supplied with this product.

**The Enterprise  
Department**

UK Head Office, 11 Bridge Street, Bishop's Stortford, CM23 2JU

Tel: 0330 331 0300\*, Fax: 01279 756595

[www.coopersofstortford.co.uk](http://www.coopersofstortford.co.uk)

EU address: D.S.B. LD, 160 Bd. de Fourmies, 59100 Roubaix, France

Tel: (+44) 1279 701269

\*UK Calls cost around 7 pence per minute plus your telephone company's network access.  
Please check with your telephone supplier.

### BATTERY SAFETY:



- **BATTERY WARNING: CONTAINS LITHIUM BUTTON CELLS. KEEP OUT OF REACH OF CHILDREN. IF SWALLOWED OR PLACED INSIDE ANY PART OF THE BODY SEEK IMMEDIATE MEDICAL ATTENTION.**





- INSTALL BATTERIES IN ACCORDANCE WITH ITS POLARITY SYMBOLS. DO NOT FIT BUTTON CELLS IN REVERSE.
- ENSURE THE BATTERY COMPARTMENT IS SECURED BY A SCREW OR SECURING DEVICE.
- IF THE BATTERY COMPARTMENT (DOES NOT CLOSE SECURELY, STOP USING THE PRODUCT AND KEEP IT AWAY FROM CHILDREN.
- REMOVE THE BATTERIES IF LEFT FOR LONG PERIODS.
- **KEEP BATTERIES AWAY FROM CHILDREN AND PETS.**
- DO NOT MIX USED AND NEW BUTTON CELLS
- **NEVER DISPOSE OF BUTTON CELLS OR BATTERIES IN A FIRE.**

### DISPOSAL:

- SPENT OR EXPIRED BUTTON CELLS MUST BE DISPOSED SAFELY AWAY FROM CHILDREN ACCESS AND RECYCLED IN COMPLIANCE WITH YOUR LOCAL AUTHORITY REGULATIONS.
- FOLLOW THE BATTERY MANUFACTURER’S SAFETY, USAGE, AND DISPOSAL INSTRUCTIONS.
- Coopers of Stortford use recyclable or recycled packaging where possible.
- Please dispose of all packaging, paper, cartons, packaging in accordance with your local recycling regulations.
- Plastics, polybags – this is made from the following recyclable plastic.



Code & Symbol	 PP	 OTHER
Type of Plastic	Polypropylene	ABS
Notes	Commonly recycled and collected from household recycling bins (packaging tape itself not recyclable but does not interfere with cardboard)	Not often or widely recycled

- At the end of the product’s lifespan please check with your local council authorised household waste recycling centre for disposal.

### CUSTOMER SERVICES:

- Customers in GB (England, Scotland and Wales), please contact our customer services - UK Head Office, 11 Bridge Street, Bishop’s Stortford, CM23 2JU, Tel: 0330 331 0300
- Customers in Northern Ireland and Europe, please contact our customer services - D.S.B. LD, 160 Bd. de Fourmies, 59100 Roubaix, France, Tel: (+44) 1279 701269



## The Enterprise Department

UK Head Office, 11 Bridge Street, Bishop’s Stortford, CM23 2JU

Tel: 0330 331 0300\*, Fax: 01279 756595

[www.coopersofstortford.co.uk](http://www.coopersofstortford.co.uk)

EU address: D.S.B. LD, 160 Bd. de Fourmies, 59100 Roubaix, France

Tel: (+44) 1279 701269

\*UK Calls cost around 7 pence per minute plus your telephone company’s network access. Please check with your telephone supplier.