

# LED Magnifying Glasses

K794 v01: 06/05/22

Please read and retain these instructions for future reference



HANOPTIK



Batteries required: 4 x CR1220 (included)

## Dimensions

(H) 4.5 x (W) 15.5cm

- THE MAGNIFICATION IS 1.6 MAGNIFICATION (160%)
- NO PRESCRIPTION REQUIRED
- POWERFUL LED LIGHT TO HELP YOU SEE BETTER IN THE LOW LIGHT
- HELP REDUCE EYE STRAIN & FATIGUE
- MAKES EVERYTHING APPEAR SHARPER AND BRIGHTER
- PERFECT FOR READING, SEWING, MANUAL WORK, JEWELLERY MAKING, MODEL MAKING AND MANY MORE
- SHATTERPROOF LENS
- FLEXIBLE
- SUPER BRIGHT CAN CONTINUE TO USE FOR 6 HOURS, AND THEN IT WILL SLOWLY DARKEN. COMPLETELY EXTINGUISHED AFTER 80 HOURS.

## Warnings

- DO NOT use LED Magnifying Glasses as eye protection.
- DO NOT look at the sun with LED Magnifying Glasses in place. Even looking close to the sun would cause immediate and irreversible damage to your eyes.
- DO NOT stare at LED lights.
- DO NOT walk with LED Magnifying Glasses in place.
- DO NOT drive or handle machines with LED Magnifying Glasses in place.
- DO NOT use solvents or alcohol to clean LED Magnifying Glasses.

## Parts

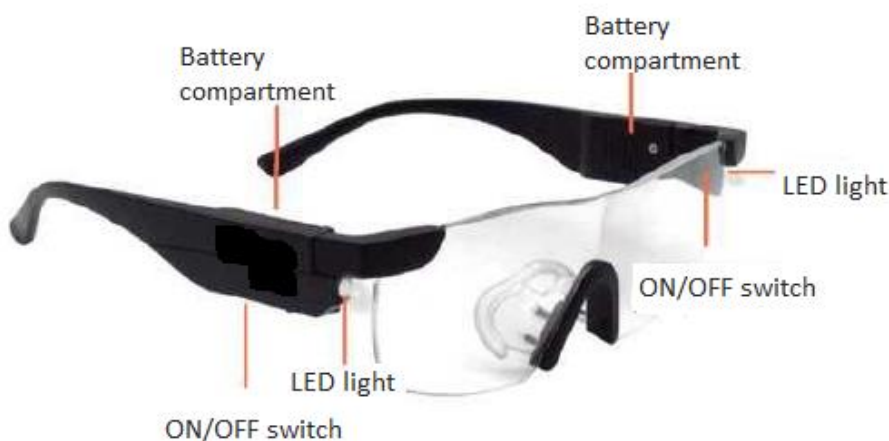

# LED Magnifying Glasses K794

Please read and retain these instructions for future reference

# Instructions for Use

v001: 06/05/22

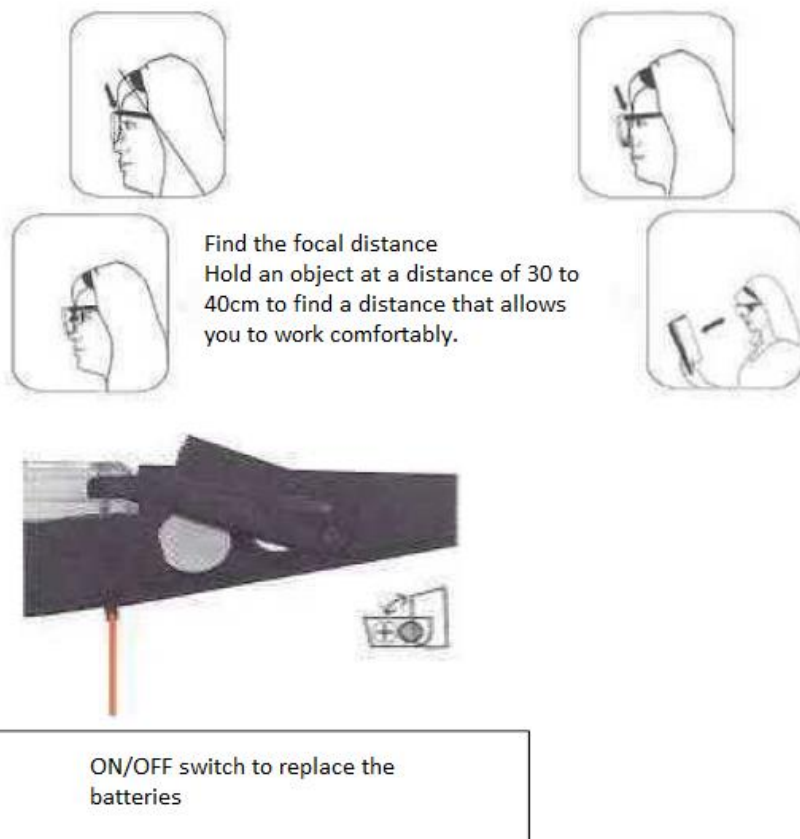

## CARE AND CLEANING:

To remove light dirt and fingerprints, use the microfiber cleaning cloth (included) or a soft cleaning wipe. If the lenses are too dirty, use water or a neutral soap to wash them.  
Do not clean glasses too much or too often, given that it could scratch them.

## BATTERIES

- Keep batteries away from children and pets.
- Do not mix used and new batteries.
- Remove the batteries if left for long periods.
- Never dispose of batteries in a fire.
- Battery disposal, spent or expired batteries must be properly disposed of and recycled in compliance with local regulations. For detailed information, contact your local authority.
- Follow the battery manufacturer's safety, usage, and disposal instructions.

## DISPOSAL

- Coopers of Stortford use recyclable or recycled packaging where possible.
- Please dispose of all packaging, paper, cartons, packaging in accordance with your local recycling regulations.
- Plastics, polybags – Contains the following recyclable plastic.



**The Enterprise  
Department**

UK Head Office, 11 Bridge Street, Bishop's Stortford, CM23 2JU

Tel: 0844 4824400\*, Fax: 01279 756595

[www.coopersofstortford.co.uk](http://www.coopersofstortford.co.uk)

EU address: D.S.B. LD, 160 Bd. de Fourmies, 59100 Roubaix, France

Tel: (+44) 1279 701269

\*UK Calls cost around 7 pence per minute plus your telephone company's network access.  
Please check with your telephone supplier.

# LED Magnifying Glasses K794

Please read and retain these instructions for future reference

# Instructions for Use

v001: 06/05/22

Code & Symbol	
Type of Plastic	Please Specify (includes ABS, Nylon)
Commonly used for	CD's, crisp packets, various flexible packaging, baby bottles, sunglass lenses
Notes	Not often or widely recycled

- At the end of the product's lifespan please check with your local council authorised household waste recycling centre for disposal.



## The Enterprise Department

UK Head Office, 11 Bridge Street, Bishop's Stortford, CM23 2JU

Tel: 0844 4824400\*, Fax: 01279 756595

[www.coopersofstortford.co.uk](http://www.coopersofstortford.co.uk)

EU address: D.S.B. LD, 160 Bd. de Fourmies, 59100 Roubaix, France

Tel: (+44) 1279 701269

\*UK Calls cost around 7 pence per minute plus your telephone company's network access.  
Please check with your telephone supplier.