

ELECTRIC PATIO CLEANING BRUSH – H062 Instructions for Use

Please read and retain these instructions for future reference

v001: 19/02/20



Contents

Technical Data.....	2
INTRODUCTION.....	2
GENERAL DESCRIPTION	3
Operating Controls.....	4
SAFETY INSTRUCTIONS	4
Symbols and Icons.....	5
ASSEMBLY INSTRUCTIONS	9
OPERATION.....	10
MAINTENANCE.....	13
STORAGE	13
DISPOSAL.....	13
EU DECLARATION OF CONFORMITY	15

ELECTRIC PATIO CLEANING BRUSH – H062 Instructions for Use

Please read and retain these instructions for future reference

v001: 19/02/20

Technical Data

Model No.	TP1604020
Voltage / Frequency	230V-240V~, 50Hz
Input Power	500W
No Load Speed	750~1,300/min
Large nylon roller brush	Ø 100 mm x 160mm width
Metal brush and nylon brush	Ø 100 mm
Protection class	Class II
Protection category	IPX0
Net Weight (without accessories)	3.20kg
- Sound pressure level(in accordance with EN 50636-2-100)	73.90dB(A) K=3dB
- Sound power level(in accordance with EN 50636-2-100)	93.90dB(A) K=3dB
- Guaranteed sound power level - (in accordance with 2000/14/EC, amended by 2005/88/EC)	95dB(A)
- Vibration(in accordance with EN 50636-2-100)	3.542m/s ² K=1.5m/s ²

ASSEMBLY INSTRUCTIONS / INSTRUCTIONS FOR USE:

Unpack the components carefully. Please check all parts have been removed from the packaging.

INTRODUCTION

Congratulations on the purchase of your new device. With it, you have chosen a high quality product. During production, this equipment has been checked for quality and subjected to a final inspection. The functionality of your equipment is therefore guaranteed.

The operating instructions constitute part of this product. They contain important information on safety, use and disposal.

Before using the product, familiarize yourself with all of the operating and safety instructions. Use the product only as described and for the applications specified.

ELECTRIC PATIO CLEANING BRUSH – H062 Instructions for Use

Please read and retain these instructions for future reference

v001: 19/02/20

Keep this manual safe and in the event that the product is passed on, hand over all documents to the third party.

USE

This device is suitable for removing weed and moss from joints between paving tiles, interlocking pavement or gutters in residential applications.

Any other use not expressly approved in the present instruction manual can damage the device and thus present a substantial risk for the user. The operator or user is liable for any accidents or personal and/or material damage incurred by third parties. The manufacture is not liable for damages caused by an improper use or incorrect operation of this device.

GENERAL DESCRIPTION

EXTENT OF THE DELIVERY

Carefully unpack the trimmer and check that it is complete. Dispose of the packaging material correctly.

-Device

-Additional handle

With spare brush storage

-1 x large Nylon roller brush

-1 x metal brush (assembled with wheel together)

-1 x nylon brush

-Instruction manual

FUNCTIONAL DESCRIPTION

The hand-operated joint brush is equipped with an electric motor.

Depending on the application requirements there are three different brushes which can be used for cleaning joint and surfaces.

The telescopic arm enables comfortable operation in an upright posture.

Please refer to the descriptions below for information about the operating devices.

ELECTRIC PATIO CLEANING BRUSH – H062 Instructions for Use

Please read and retain these instructions for future reference

v001: 19/02/20

Operating Controls

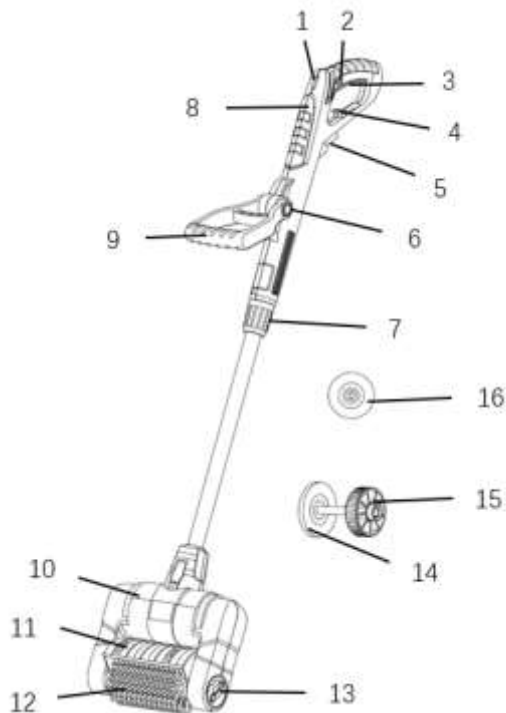

- 1 Speed regulator
- 2 Switch lock
- 3 Switch trigger
- 4 Cable holder
- 5 Cable
- 6 Angle adjustment button for auxiliary handle
- 7 Lock knob for length adjustment
- 8 Main handle
- 9 Auxiliary handle
- 10 Motor head
- 11 Splash guard
- 12 Roller plastic brush
- 13 Brush assembly knob
- 14 Narrow metal brush
- 15 Wheel
- 16 Narrow nylon brush

Noise and vibration values have been determined according to the standards and regulations mentioned in the declaration of conformity.

The stated vibration emission value was measured in accordance with a standard testing procedure and may be used to compare one power tool to another. The stated vibration emission value may also be used for a preliminary exposure assessment.



WARNING: The vibration emission value may differ during actual use of the power tool from the stated value depending on the manner in which the power tool is used. Safety precautions aimed at protecting the user should be based on estimated exposure under actual usage conditions (all parts of the operating cycle are to be considered, including, for example, times during which the power tool is turned off and times when the tool is turned on but is running idle).

SAFETY INSTRUCTIONS



CAUTION! When using power tools, observe the following basic safety measures for the prevention of electric shocks and the risk of injury and fire.

Please read all these instructions before using the electric tool and please keep the safety instructions.











ELECTRIC PATIO CLEANING BRUSH – H062 Instructions for Use

Please read and retain these instructions for future reference

v001: 19/02/20

Symbols and Icons

Symbols on the device

	Read the operating instruction manual before using the appliance.		Danger due to materials blown out of machine! Remove persons in the vicinity from the danger area.
	Risk of injury from the rotating tool! Keep hands and feet away.		CAUTION! Disconnect the plug before cleaning and repair work.
	Do not use this product in the rain or leave outdoors while it is raining.		Remove plug from the mains immediately if cable is damaged or cut.
	Wear eye protection		Wear dust mask
	Class II tools symbol		In accordance with essential applicable safety standards of European directives
	Electrical appliances must not be disposed of with the domestic waste.		

SYMBOLS IN THE MANUAL



Warning symbols with information on damage and injury prevention.



Hazard symbol with information on the prevention of personal injury caused by electric shock.



Instruction symbols with information on preventing damage.



Help symbols with information on improving tool handling.

ELECTRIC PATIO CLEANING BRUSH – H062 Instructions for Use

Please read and retain these instructions for future reference

v001: 19/02/20

GENERAL SAFETY INSTRUCTIONS

Operating the Multi-Brush



CAUTION: How to avoid accidents and injuries.

Preparations:

This appliance can be used by children aged from 8 years and above and persons with reduced physical, sensory or mental capabilities or lack of experience and knowledge if they have been given supervision or instruction concerning use of the appliance in a safe way and understand the hazards involved. Children shall not play with the appliance. Cleaning and user maintenance shall not be made by children without supervision.

- Never allow children and people who are not familiar with these operating instructions to use the device.
 - Recommended for use by persons over 18 years of age.
 - Please make sure that no other persons or animal are present in your work area. Never let any person touch the device or cable. Keep away from children!
 - Always wear suitable clothing and personal protective equipment when operating the device.
 - Wear safety goggles. A failure to wear safety goggles can cause eye damages from ejecting objects.
 - Always wear ear protectors when operating the device.
 - Wear boots or shoes with anti-slip soles, long trousers and work gloves. Never use the device barefooted or wearing open sandals.
 - Never use the equipment if it is damaged incomplete or has been modified without the approval of the manufacturer.
 - Never operate the equipment if the protective equipment is defective. Before starting up the equipment always check that the equipment is in a perfectly safe condition, especially the power cable, the switch and the protective cover.
 - Never disconnect or remove any protective devices (splash guard). This ensures that the equipment remains safe.
 - Always use a RCD protected plug socket when connecting to the internal domestic mains supply.
 - If using an extension lead, ensure this is undamaged and plugged into a RCD plug indoors.
- **USE:**
- Always maintain a secure footing while working. Be especially carefully when working on a sloping terrain.
 - This enables you to control the equipment better in unexpected situations.
 - Do not operate the equipment if you are tired or lack concentration and after having drunk alcohol or taken medication. Always take a work break in due time. A moment of carelessness when using the equipment can result in serious injury.
 - Do not use the equipment while it is raining, in poor weather conditions and when the surrounding area is wet. Only work when the light conditions are good.
 - There is a risk of accidents.
 - Keep the brush away from all body parts and in particular hands and feet when starting the motor or when the motor is running.

ELECTRIC PATIO CLEANING BRUSH – H062 Instructions for Use

Please read and retain these instructions for future reference

v001: 19/02/20

- Never start the equipment when it is turned over or not in the correct working position.
- Switch off the motor and disconnect the plug from the mains socket:
 - -Whenever you are not using the equipment
 - -If the equipment is left unattended.
 - -When the equipment is being cleaned, maintained or is to be inspected.
 - -When relocating the equipment.
 - -If the power or extension cable is damaged.
 - -When you remove or exchange the cutting device or manually adjust the length of cutting line.
- Never try to stop the brush with your hands. Always wait until the brush stops rotating.
- Do not use the device for removing weed or moss not growing on the ground, i.e. moss growing on walls or rocks etc.
- Always inspect the brush before starting the device. Never use damaged brushes. Replace any damaged or worn brush.
- The brush must not be mounted on device with an engine speed exceeding the admissible maximum engine speed of the brush.
- Do not traverse gravel paths while the equipment is operating. Gravel can be thrown up and result in injury.
- Do not operate the equipment in the vicinity of inflammable liquids or gases as they could give rise to the danger of a fire or explosion.
- Store the equipment in a secure dry place that is not accessible by children.



CAUTION! The following states how damage to the equipment and possible injury to people can be avoided:

Taking care of the equipment:

Ensure that the ventilation openings are not clogged.

Only use spare parts and accessories that have been supplied or recommended by the manufacturer.

Never try to repair the equipment yourself. All work that has not been listed in these instructions must only be carried out by an authorized servicing agency.

Treat the equipment with the greatest care. Always keep the equipment clean for better and safe work.

Follow the maintenance instructions.

Never overload the equipment. Always work within the stated capacity range. Do not use low-power machines for heavy-duty work. Do not operate the equipment for purposes for which it is not intended.

Always inspect the equipment before it is to be used. Do not operate the equipment if safety devices, parts of the cutting device or bolts are missing, worn out or damaged.

ELECTRICAL SAFETY:



CAUTION! The following states how to avoid accidents and injuries due to electric shock:

Page No. 7

Head Office, 11 Bridge Street,
Bishop's Stortford CM23 2JU
Tel: 0844 482 4400*
Fax: 01279 756 595
www.coopersofstortford.co.uk

Coopers
OF STORTFORD

*Calls cost 7 pence per minute plus your
telephone company's network access charge

ELECTRIC PATIO CLEANING BRUSH – H062 Instructions for Use

Please read and retain these instructions for future reference

v001: 19/02/20

Never cross the power cable while the device is operating.

Always keep the power cable behind the device operator.

Should the power cable become damaged during work, then instantly disconnect the power cable from the mains.

DO NOT TOUCH THE POWER CABLE BEFORE IT HAS BEEN DISCONNECTED FROM THE MAINS! Risk of electric shock.

Before each usage, check the mains power cable and the extension cable for damage and signs of aging. Do not use the device if the cable or plug is damaged or worn. Damaged mains power cables and plugs increase the risk of electric shock.

If the power cable for this equipment is damaged, it must be replaced by the manufacturer, a customer service agent of the same or a similarly qualified person in order to prevent hazards.

Check that the mains voltage is the same as indicated on the rating plate.

Connect the equipment to a power socket with a residual-current circuit breaker that has a rated current of not more than 30mA.

Protect the equipment from moisture. The equipment must not be moist nor operated in a moist environment. Water entry into the equipment increases the risk of electric shock.

Avoid body contact with earthed parts (e.g. metal fences, metal posts). There is an increased risk of electric shock if your body is earthed.

Only use extension cables with a maximum length of 75m that have been approved for open-air use. The stranded cord diameter of the extension cable must be at least 2.5mm². Always unwind a cable drum to its full length so that the entire cable can be inspected for damage.

Use the envisaged cable suspensions when attaching an extension cable.

Never carry the equipment by its power cable. Never pull the cable to disconnect the plug from the mains socket. Protect the cable from heat, oil and sharp edges. The mains power cable could be damaged.

SERVICE

Have your power tool serviced by a qualified repair person using only identical replacement parts. This will ensure that the safety of the power tool is maintained.

RESIDUAL RISKS

Even if properly operating and handling this electric tool, some residual risks will remain. Due to its construction and build, this electric tool may present the following hazards:

- a) Eye damage if working without eye protection.
- b) Ear damage if working without ear protection.
- c) Damage to your health caused by swinging your hands and arms when operating the appliance for longer periods of time or if the unit is not held or maintained properly.

ELECTRIC PATIO CLEANING BRUSH – H062 Instructions for Use

Please read and retain these instructions for future reference

v001: 19/02/20



Warning! During operation, this electric tool generates an electromagnetic field which, under certain circumstances, may impair the functionality of active or passive medical implants. To reduce the risk of serious or lethal injuries, we recommend that persons with medical implants consult their doctor and the manufacturer of their medical implant before operating the machine.

ASSEMBLY INSTRUCTIONS



The narrow metal brush (14) and wheel (15) are assembled together, which are packaged as accessories and narrow plastic brush (16) in an inner box.

Pull out the Multi-brush body from colour box. In order to save package size, we adjust the angle of the main handle before we pack it, Please release the knob(step1) and rotate 90° (step2) to adjust to correct position. Refer to Fig. 1

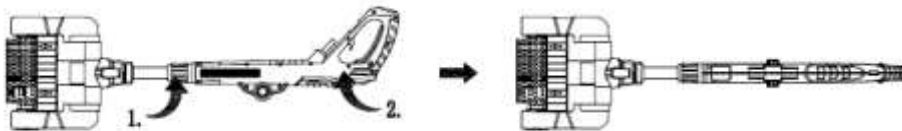

Fig. 1

1. Mounting the auxiliary handle and adjusting the angle. Refer to Fig.2

- Press the adjusting knob (6). (step1)
- Insert the auxiliary handle(9) into the main handle(8), then release the adjusting knob(6).(step2)
- Press the adjusting knob (6) to adjust the angle of auxiliary handle to your preferred position.

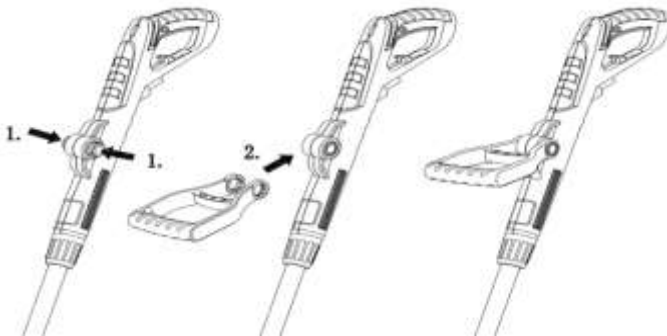

Fig. 2

2. Inserting / replacing the brush

- Disassemble roller plastic brush (12), Refer to Fig.3

Press the knob (13) and turn it counter clockwise. You can pull out the knob and remove the roller plastic brush.

ELECTRIC PATIO CLEANING BRUSH – H062 Instructions for Use

Please read and retain these instructions for future reference

v001: 19/02/20

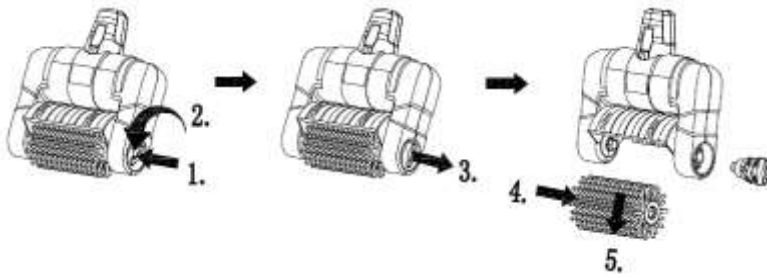

Fig. 3

B. Assemble the roller plastic brush or metal brush. Refer to Fig.4



Please note that the size of hexagonal inner hole at both ends of brush is different. Refer to Fig.5

Press the knob (13) and then turn it clockwise, and release holder hand as the knob cover pops out and locks the brush.

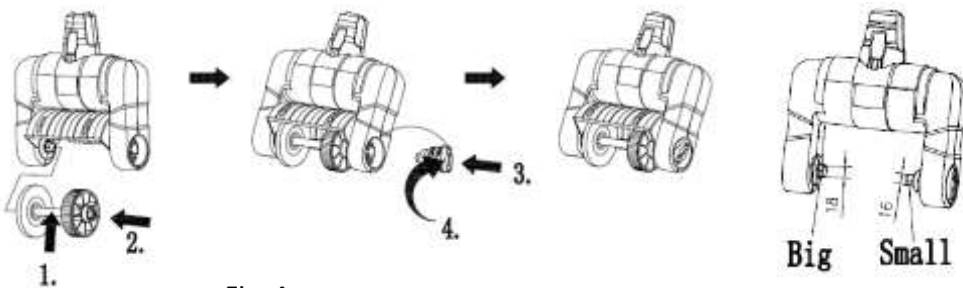

Fig. 4

Fig. 5

C. Assemble and replace the narrow metal and narrow plastic brush. Refer to Fig. 6

Use a cross screwdriver to release/fasten the screw to replace the brush.

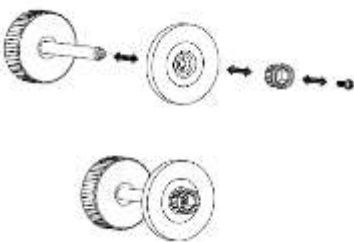

Fig. 6

OPERATION



Caution, risk of injury!

Always check whether the device function correctly before using it.

Always wear eye protection when operating the device.

ELECTRIC PATIO CLEANING BRUSH – H062 Instructions for Use

Please read and retain these instructions for future reference

v001: 19/02/20



Always unplug the device before working on it. There is a risk of injury.



Observe the noise protection and other local regulations.

SWITCHING ON AND OFF

1. Loop the end of the extension cable and hang it onto the cable tension relief (4) to ease the tension on the cable.
2. Plug the tool into the mains.
3. To turn on, use your thumb to actuate the switch lock (2), then press the switch trigger(3). Release the switch lock.
4. To turn off, release the switch trigger (3). There is no continuous operation mode.



The brush will keep rotating for a few seconds after the device has been switched off. Keep the brush away from hands and feet.



Do not try to lock the switch trigger in place. Do not use the device if the switch is damaged.

A damaged switch may cause an injury risk due to the motor not being switched off after releasing the switch trigger.

DEVICE ADJUSTMENTS

Length adjustments:

The telescopic arm enables you to adjust the device to your individual height.

Unfasten the lock knob (7), adjust the telescopic arm to the desired length and re-fasten the lock knob.

Adjusting the splash guard:

You can adjust the splash guard (11) by sliding it backwards and forwards.

Setting the rotation speed:

There are infinitely variable speed controller setting on the speed regulator (1).

PRACTICAL TIPS



Caution, risk of injury!

Always inspect the brush before starting the device. Never use damaged brushes, replace any damaged or worn brushes.

Use original brushes only.

ELECTRIC PATIO CLEANING BRUSH – H062 Instructions for Use

Please read and retain these instructions for future reference

v001: 19/02/20

Never operate the device in the rain or on wet ground. Operating the device in rain or on wet ground can cause an electric shock.

Always move across the slope when working on hills.

Avoid any contact with fixed obstacles (rocks, walls, picket fences, etc.) in order to prevent damages to the device.

Switch off the device during breaks or when transporting it and wait until the brush has completely stopped rotating.

USING THE DEVICE:



Never move the brush across plastic or other flooring material while it is in operation. The brushes could scratch or damage the surface.

We do not assume any liability for damages in this case.

Operate the device at walking speed.

The arrow  on the spray guard indicates the brush's rotational direction.

Always test the device in an inconspicuous area before using it on sensitive floors.

SELECTING THE PROPER BRUSH

For information on replacing the brush, please refer to the "ASSEMBLY INSTRUCTIONS" section.

NARROW METAL BRUSH (14):

Select this brush for removing persistent lichens and moss **on robust grounds**.



Use the metal brush on robust surfaces only (road pavement) as it may damage and/or scratch the ground.

NARROW PLASTIC NYLON BRUSH (16):

Select this brush for removing weed lichens and moss **from small narrow joints**.

ROLLER PLASTIC BRUSH (12):

Select this brush for removing weed, lichens and **moss from wide joint and cleaning smaller areas**.

CLEANING AND MAINTENANCE



Always unplug the device before working on it.



Any work that is not described in these instructions must be carried out by a servicing agency authorized by us. Danger of injury!

ELECTRIC PATIO CLEANING BRUSH – H062 Instructions for Use

Please read and retain these instructions for future reference

v001: 19/02/20

CLEANING



Do not jet water onto the trimmer and do not clean it under flowing water. This would result in the danger of an electric shock and the trimmer could be damaged.

Always keep the device clean. Do not use cleaning agents and solvents.

Clean the device, brush and splash guard with a soft brush or cloth after every use.

Keep the louvres clean.

MAINTENANCE



Only use spare parts and accessories that have been supplied or recommended by the manufacturer.

Always inspect the equipment before it is to be used. Do not operate the equipment if safety devices, parts of the cutting device or bolts are missing, worn out or damaged.

Always inspect the brush before starting the device. Never use damaged brushes. Replace any damaged or worn brush.

STORAGE

Store the appliance in a dry place well out of reach of children.

Do not expose the device for extended periods to direct sunlight. This could damage the device.

Do not warp plastic sacks around the appliance as this could result in the formation of moisture and mould.

DISPOSAL

- Dispose of all packaging, paper, cartons, plastic and plastic bags in accordance with your local recycling regulations.
- Plastics – This is made from the following plastic.

Polyethylene Terephthalate	High-Density Polyethylene	Polyvinyl Chloride	Low Density Polyethylene	Polypropylene	Polystyrene



- Aluminium – the handle is made from the following Aluminium
- At the end of the product's lifespan please dispose of it at an authorised household WEEE waste recycling centre.



ELECTRIC PATIO CLEANING BRUSH – H062 Instructions for Use

Please read and retain these instructions for future reference

v001: 19/02/20

EC DECLARATION OF CONFORMITY

Coopers of Stortford that the Electric Patio Cleaning Brush G589, (Model No. **TP1604020**)

Conforms to the following European Directives and standards

2006/42/EC, 2006/95/EC, 2014/30/EU, 2011/65/EU (EU)/2015/863

and are manufactured in accordance with the following standards or standardized documents:

2006/42/EC-Annex I, EN 60335-1:2012/A13:2017, EN 50636-2-91:2014, EN62233:2008

EN 55014-1: 2017, EN 55014-2: 2015, EN 61000-3-2: 2014, EN 61000-3-3: 2013

Additionally confirmed by the Directive 2000/14/EC Noise emission:

Sound power level:

Measured: 93.90dB(A)

Guaranteed: 95 dB (A)

ELECTRIC PATIO CLEANING BRUSH – H062 Instructions for Use

Please read and retain these instructions for future reference

v001: 19/02/20

Machinery declaration of conformity for manuals

EU DECLARATION OF CONFORMITY

Coopers of Stortford hereby declare under our sole responsibility, that the product named below has been designed to comply with all relevant sections of the below referenced standards and directives: -

Description & item Number: Electric Patio Cleaning Brush
Model No: H062

Conforms to the following: -

- Machinery Directive 2006/42/EC
- Low Voltage Directive 2014/35/EU
- EMC Directive 2014/30/EU
- Noise Directive 2000/14/EC & 2005/88/EC
- Guaranteed sound power level 95dB.
- RoHS Directive 2011/65/EU & 2015/863/EU

The Technical file in accordance with 2006/42/EC is available from:
Coopers of Stortford, 11 Bridge Street, Bishop's Stortford, Hertfordshire, CM23 2JU

